

ELR101

Earth Leakage Relay

Safe and Simple Earth Leakage Protection for Motor Control



- **Safe to Reset**
 No power necessary for a Reset - Can be carried out on a totally isolated panel
- **Fail-Safe operation**
 Alarm condition flagged in the event of Power Loss
- **Wide Trip Range and Trip Delay**
 30mA to 36 Amp. 0.1 second to 10 seconds
- **Protected against False Reset**
 Alarm condition is latched and cannot be cleared by a Power Loss

ELR101 is an earth leakage trip relay designed to give a simple system of protection for motor control gear.

It operates from one of a dedicated range of special core balanced current transformers which, combined with the sensitivity control, give an overall trip range from 30mA to 36 Amps. A trip delay is settable between 0.1 and 10 seconds. These two user controls cater for a wide range of installations. In the event of a trip occurring, **the reset operation may be carried out with the panel totally isolated - with no auxiliary supply to the ELR101.** The trip condition is signalled on isolated, double pole, changeover relay contacts.

A test push button provides a method of checking for correct operation, a green LED indicates the relay is powered, while a red LED shows a trip condition. The relays are "Fail Safe", alarm conditions are flagged in the event of power loss.

All transformers have a test winding, allowing simple testing of the whole system - Relay & Transformer.

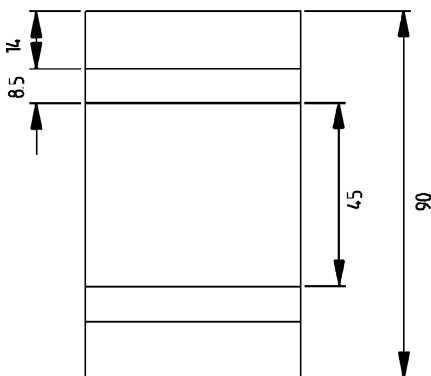
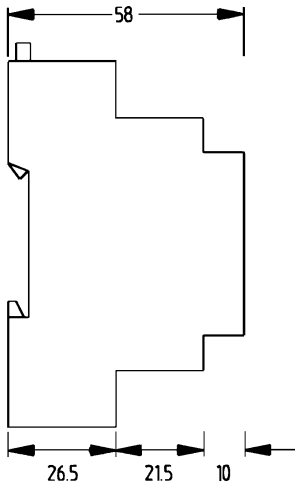

SPECIFICATION ELR101

Auxiliary Supply	230 or 115VAC ($\pm 15\%$) 50-60Hz 5VA Internal Fuse 50mA (T)
CT Input	6mA Nominal FS
Relay Contacts	Double Pole Changeover 5A, 230VAC, 120W Resistive 2.5A, 230VAC, 75W Inductive
Isolation	2.5kV, 1 minute (CT/Relay/Supply)
Terminals	4mm ² max. Cable Size
Trip Delay Accuracy	100ms to 10 seconds $\pm 5\%$ of preset value
Trip Current Accuracy	30% to 120% of CT Sensitivity $\pm 10\%$ of preset value
Enclosure	DIN 43880, 3 modules Wide Noryl UL94VO
Rail	DIN EN 50022 - 35mm
Environment	
Operating	-10°C - 60°C <75% Non Condensing
Storage	-25°C - 70°C < 85% Non Condensing

Core Balance Current Transformers

Part No	Trip Range	Internal Diam	Max FLC.
K1029	30 to 120mA	N/A	5A
K1028	100 to 360mA	N/A	15A
K1027	0.3 to 1.2A	N/A	25A
K1025	0.3 to 1.2A	23mm	N/A
K1024	1.0 to 3.6A	40mm	N/A
K1023	3.0 to 12.0A	55mm	N/A
K1022	10.0 to 36.0A	90mm	N/A
K1021	10.0 to 36.0A	72x290mm	N/A
K1020	3.0 to 12.0A	72X290mm	N/A

NOTE

The ELR101 and its associated CTs are designed to protect against fire hazard on electric motors **AND MUST NOT BE USED FOR LIFE PROTECTION**

Elektro - Trading sp. z o.o.

ul. Mechaników 9, 44-109 Gliwice
Tel.: (032)734-55-72 Tel/Fax: (032)734-55-70
E-mail: et@elektro-trading.com.pl
<http://www.elektro-trading.com.pl>